

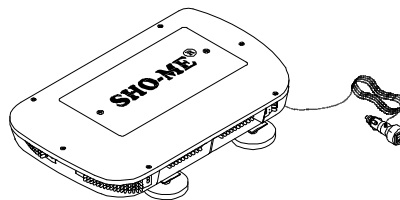

Model No. 32.LED18.008
18" LED Mini Bar – Magnetic Mount
With Selectable Patterns



GENERAL INFORMATION:

The SHO-ME® LED Mini Bar is equipped with a Solid State Flasher that has both selectable Flash Patterns and selectable Head Mapping Patterns. When shipped from Able 2 Products Co. it is set in the Random Flash pattern and Random Head Mapping pattern. To change flash pattern, press the momentary switch (Located on the lighter plug adaptor). Each time the momentary switch is pressed, the flash pattern will change. To change Head Mapping Patterns, locate "Head Mapping" button on bottom of LED Lightbar. With lightbar flashing, push "Head Mapping" button until flashing stops, then release to go to next Head Mapping Pattern.

INSTALLATION INSTRUCTIONS:

Determine location to mount LED Mini Light Bar. Keep in mind airbag deployment area and any other obstacles. Run wire inside of vehicle and connect to cigarette plug, or power outlet.

WARNING: The steel content of vehicle roofs varies considerably and some may not be suitable for mounting warning lights with magnetic bases. **It is the sole responsibility of the users** of magnetic based lights to determine if portable warning lights may be safely used on the exterior of their vehicle.

Flash Patterns

- | | |
|-------------------------|----------------------------|
| 1. Quad Flash | 5. Mega Flash |
| 2. Single Flash | 6. Sequence |
| 3. Single Flash - Super | 7. Automatic Random Select |
| 4. Double Flash | |

Head Mapping Patterns

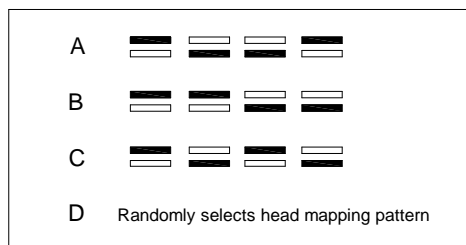

— = ON

□ = OFF



PRODUCTS COMPANY • 804 East Hwy. 248 • Cassville, MO 65625
U.S. and Canada Toll Free Numbers • Phone: 800-641-4098 FAX: 800-526-1240
E-mail: sales@able2products.com WEB: www.able2products.com

Parts List for 32.LED18.008 18" LED Mini Bar – Magnetic Mount

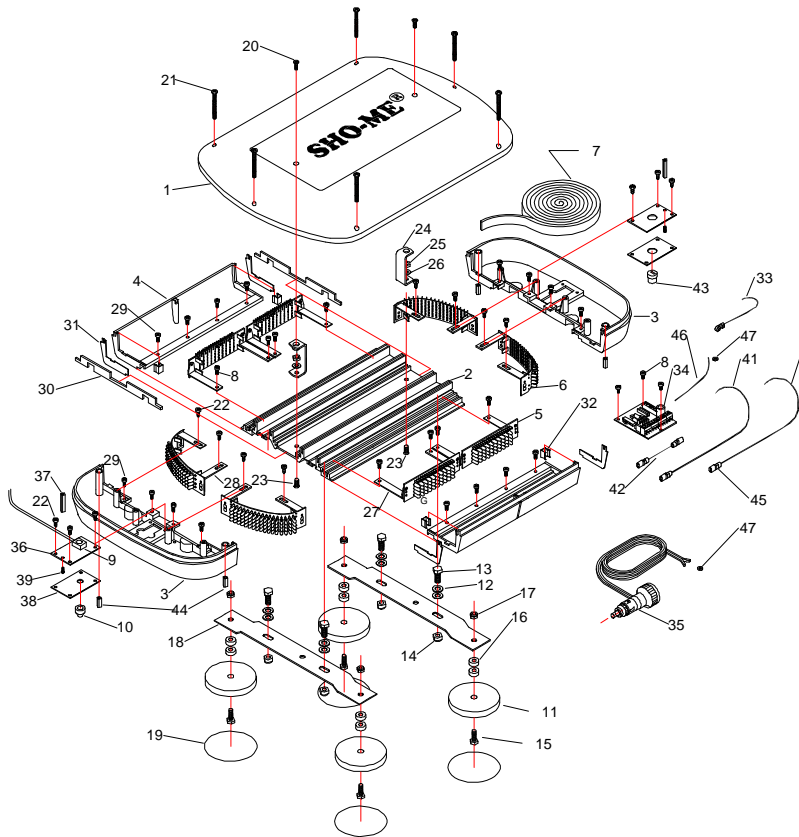

ITEM	MODEL NO.	DESCRIPTION	QTY
1	90.6118.000	LED Lightbar Cover	1
2	70.622-2T0000	2000 Main Extrusion Thin (11 ¹⁶ / ₆₄ "	1
3	70.41C-L2EL	Clear Lens 2000E End Lower	2
4	70.41C-L2MLS	Clear Lens 2000 Lower Short	2
5	95.3730.(Color)	PC Board Short LED Lightbar Red	4
6	95.3830.(Color)	PC Board/Lightbar Corner LED	4
7	90.6039.000	1/8" X 3/4" Black Foam Adhesive (53")	1
8	70.024-122	MM4X8MM Phil Pan Head Bolt SS	11
9	90.3472.000	J188A Head Map Switch	1
10	90.4119.000	J961 Boot	1
11	90.4250.000	3/4" Do-Nut Magnet	4
12	90.4522.000	1/4 X 1 Fender Washer 18-8 SS	8
13	70.024-123	M8-1.25X20 Hex Hd Bolt 18-8 SS	4
14	70.024-124	M8-1.25 Nyl Ins Lk Nut 18-8 SS	4
15	90.4490.000	1/4-20 X 3/4 Hex Hd Bolt SS	4
16	90.6919.000	Spacer .250 X .562 X .250	8
17	90.4150.000	1/4-20 Nylon Insert L/N NTE SS	4
18	90.4958.000	Brks/Stealth 14 Ga SS (w/out mag)	2
19	90.6140.000	3.200 Diameter Vinyl Discs White	4
20	90.4079.BLK	1/4 X 20 X 3/4 Phil Screw Bl Ox	2
21	90.4177.SSBO	Phil Pan M/S 18-8 SS BL	6
22	90.4002.000	#8 X 1/2 812	14
23	90.4048.BLK	1/4 - 20 X 1/2 PEM S-C Stud BL Zin	2
24	90.5000.000	Alu Brkt for LT Bar Lid	2
25	90.4575.000	1/4" X 20 Thin Hex Nuts Zinc Pl	2
26	90.4540.000	1/4" Lockwasher Internal Tooth	2
27	90.4202.000	Alum Brkt for Linear LED/LBar	8
28	90.4201.000	Alum Brkt for LED in Lightbar	8
29	90.4002.000	01-0143 #8 X 1/2 812	16
30	70.432-001	2000 Extrusion Gasket	2
31	70.430-2KL	2000 Lens Joining Tape Set	4
32	70.060-011	Spring Clip	4
33	61.0651.000	7" Cable Ties	3
34	90.3728.000	8 Output LED Flasher Board	1
35	90.3281.000	Plug w/ON/Off & Morn Switch	1
36	70.620-201.PHTM	Cable Cover	2
37	90.6721.000	HSX-10 Hex Spac- 1/4 OD 1 1/4"	2
38	70.432-002	2000 Cable Cover Gasket	2
39	90.4044.000	1/2" FH632 - 8- ZI S/Clinch Stud	2
40	41.0181.010BLK	Black 18 GA RVI Wire (1 FT)	8
41	41.0181.010YEL	Yellow 18 GA RVI Wire (1 FT)	2
42	41.0181.010RED	Red 18 GA RVI Wire (3')	8
43	90.6430.000	#1167 Heyco Strain Relief Bushing	1
44	90.4382.000	3/8" #6-32 Hex Alum Spacer	4
45	83.0258.000	Nylon 16-14 GA Female Full Ins	22
46	41.0181.010BLK	Black 18 GA RVI Wire (4")	1
47	70.004-030R	Ground Wire Washer	2

LIMITED WARRANTY

Able 2 Products Company warrants each new product (except bulbs, strobe tubes, strobe power supplies and LED products) to be free from defects in material and workmanship for a period of two years from the date of purchase. During this warranty period, the obligation of Able 2 is limited to repairing or replacing, as Able 2 may elect, any part or parts, which after examination by Able 2 are determined to be defective, when they are delivered pre-paid. This limited warranty does not cover travel expense, the cost of specialized equipment for gaining access to the product, or labor charges for the removal and re-installation of the product.

Able 2 Products Company shall not be liable for incidental or consequential damages, including but not limited to: Loss of use of vehicle, Rental of substitute vehicle, Loss of time, Loss of work, Inconvenience, Transportation expenses, Telephone, Lodging, Loss of revenue, Loss of and/or damage to personal property for or arising out of breach of any express or implied warranty of its products.

Use of lamp or other electrical load of wattage higher than installed or recommended by the factory, or use of inappropriate or inadequate wiring or circuit protection causes this limited warranty to become void. Able 2 Products Company will in no way be liable for any loss of profits or any indirect or consequential damages arising out of any such defect in material and workmanship whether loss is due to negligence or breach of warranty. This limited warranty does not apply to shipping damage, accident, alteration, tampering, misuse or abuse and unauthorized service.

This limited warranty is expressly in lieu of all other express or implied warranties, including the implied warranty of merchantability and the implied warranty of fitness for a particular purpose, and of all other obligations or liabilities on the part of Able 2 Products Company. There are no warranties, unless expressed in authorized Able 2 literature, which extend beyond the description of the face hereof. No dealer, distributor, employee, or representative of the company is authorized to change this warranty in any way or to grant any other warranty.

WARRANTIES:

All LED Products	5 Years
T Model & Potted Strobe Power Supplies.....	2 Years
All Other Strobe Power Supplies.....	5 Years
All Other Products EXCEPT Bulbs.....	2 Years (under normal use)
Strobe Tubes.....	1 Year (under normal use)

NOTE: Halogen and Incandescent Bulbs are not covered by warranty.

If a product must be returned, contact our factory by calling 1-800-641-4098 to obtain a Return Authorization Number (RA) before you ship the product. Write the RA Number clearly on the package and return to Able 2 products Company, P.O. Box 543, 804 E. Hwy. 248, Cassville, MO 65625-0543. A packing slip should be included with all shipments listing the sender's name, address, daytime phone number and description of defect. Your product will be put in first-class operating condition or replaced with a new part, and returned pre-paid.